

Raga – Horizontal / Vertical Exterior Bollard

kreon

Date: _____ Customer: _____

Project: _____

Type: _____ Qty: _____



kreon raga is an exterior bollard luminaire with a simple, timeless form that is complimented by a choice of stone or steel material finishes that define its personality. The units are sealed to IP65 and are fitted with warm LEDs to provide an attractive surrounding glow.

Construction

Luminaire

Made from high-pressure die cast aluminum. Surface treatment by powder-coated.

Stone/Steel Finish

- Nero marquina
- Metal Black
- Carrara bianco

Mounting Option

- Horizontal or Vertical
- Surface mounted luminaire for floors

Classifications

- Ingress Protection – IP66 (horizontal) and IP65 (vertical)



Electrical Characteristics

LED Specification

- LED.

LED Life

- Up to 12W

Correlated Color Temperature (CCT)

- Available in 2700K.
- CRI 80+

Gear

Standard 120V driver with on/off function (no dimming). Consult factory for TRIAC phase dim or 0-10V dim.

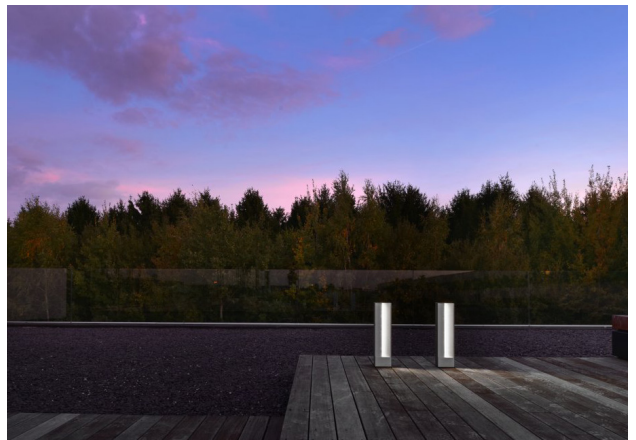

Raga – Horizontal / Vertical Exterior Bollard

kreon

Ordering Codes

KU__ -	27 -	80 -	__ -	__ -	INT -	__ -
KREON RAGA	LIGHT SOURCE AND CCT*	CRI	STONE / STEEL FINISH	FRAME FINISH*	ELECTRIC GEAR	OPTIONAL ACCESSORIES
RH – Horizontal RV – Vertical	27 – 2700K	80 – 80+ min CRI	NM – Nero marquina marble BLK – Metal black CB – Carrara bianco marble	BFF – High gloss black frame finishing BSS – Brushed stainless steel frame finishing BRC – Brushed red copper frame finishing	INT – Integral 120V	CP – Concrete pouring mould

Ordering Example: KURV-27-80-NM-BRC-INT-CP

* Consult factory for other options

Photometry — For full photometry, please reference IES files on www.kreon.com

KURH-27-80-BLK-INT (no accessories)

Source Lumens: 540 lumens
Maximum Candela: 5649.59
CCT: 2700K
CRI: 80+
Power: 12W
Luminaire Output:
540 lumens (45 lm/W)

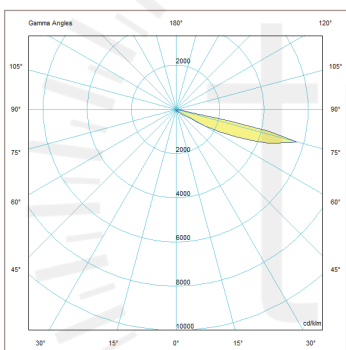

KURV-27-80-BLK-INT (no accessories)

Source Lumens: 85 lumens
Maximum Candela: 1489.06
CCT: 2700K
CRI: 80+
Power: 5W
Luminaire Output:
85 lumens (17 lm/W)

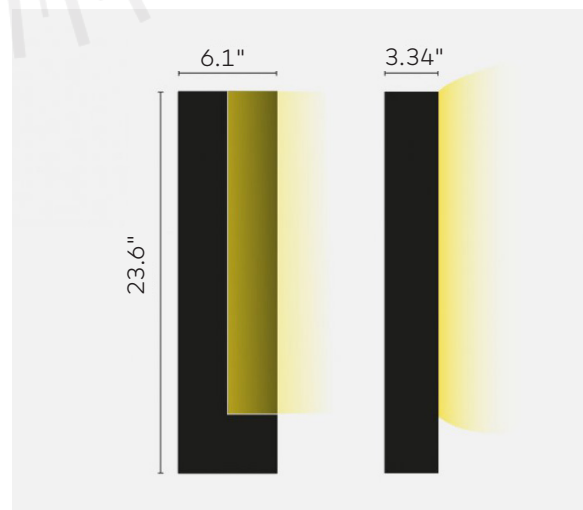
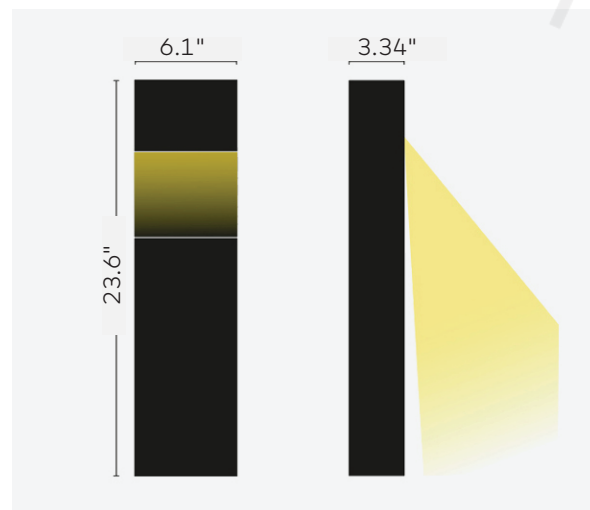
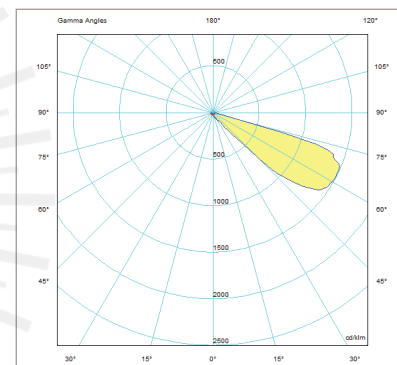

Mounting/Installation

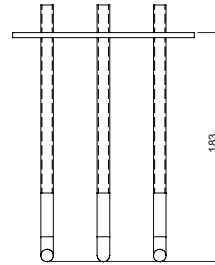
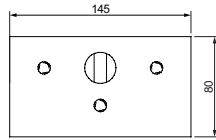
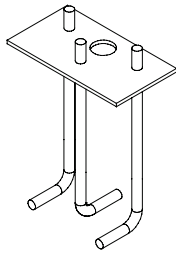

1. Raga Concrete Anchor

2. Make sure main voltage is disconnected before proceeding

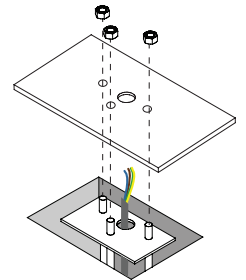
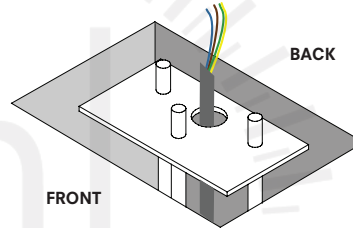
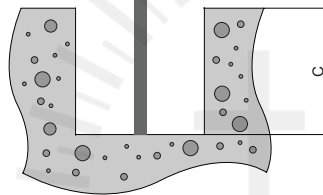
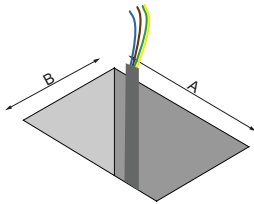

3. Make a hole with following minimum dimensions: $A_{min}=155$ $B_{min}=90$ $C_{min}=183$ Provide 120v power supply and earthing cable

4. Place anchor in hole, mind the orientation. Pull cables through the opening. Make a plate (provided by others) and attach it to the anchor so it can be correctly positioned and stays in place.

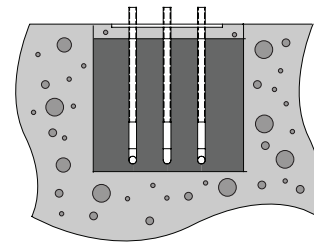
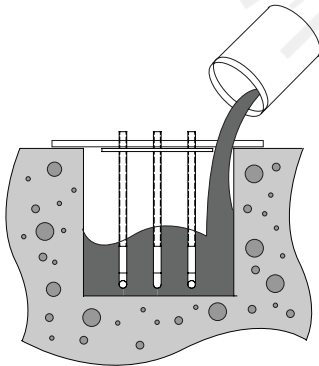

5. Make sure the top surface of the anchor is flush with the ground. Make sure the anchor is leveled. Pour concrete.

6. Fill up hole with ground material.